

OPERATOR'S MANUAL

611305-C

INCLUDING: OPERATION, INSTALLATION & MAINTENANCE
ALSO INCLUDE MANUALS: WITH 611305-C - 635142-B METER,
WITH 611306-C - 635151 METER AND 635101 FILTER.

RELEASED:03-08-84
REVISED:08-15-93
(REV. B) IPP/PSE

2:1, 4:1 OR 7:1 RATIO
100 OR 120 LB. DRUM W/DOLLY

611305-C and 611306-C HAND OPERATED PUMPS

**IMPORTANT: READ THIS MANUAL CAREFULLY BEFORE INSTALLING,
OPERATING OR SERVICING THIS EQUIPMENT.**



611305-C

METERED FOR GEAR OIL DISPENSER
INCLUDES: 635142-B METER, 621502-05 HOSE & NOZZLE ASS'Y

611306-C

METERED A.T.F. DISPENSER
INCLUDES: 635151 METER, 621593-07 HOSE & NOZZLE ASS'Y



2:1 RATIO POSITION
LIGHT VISCOSITY
FLUIDS

4:1 RATIO POSITION
MEDIUM VISCOSITY
FLUIDS

7:1 RATIO POSITION
HEAVY VISCOSITY
FLUIDS

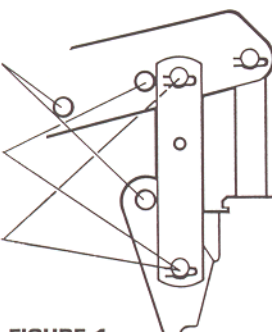

FIGURE 1

MULTI-PURPOSE HAND OPERATED PUMP RATIO ADJUSTMENT

The ARO multi-purpose hand operated pumps are designed so the ratio can be easily adjusted to handle any viscosity fluid. The diagram illustrates the location of the linkage to obtain any one of the three different ratios.

The lower the ratio set, the more volume of fluid will be dispensed with each stroke. However, the heavier the viscosity of the fluid, the higher the ratio should be and the volume per stroke will be reduced accordingly. Therefore, the unit should be set at the ratio at which you receive the most volume and the unit still operates with an easy stroking effort.

TROUBLE SHOOTING

1. If you are unable to operate pump, the ratio setting may be too low for material being pumped. If this is not the case, check suction tube for damage or obstruction.
2. If pump operates, but dispenses little or no lubricant, remove 37, 38, 39 40 intake valve assembly, check for foreign matter which may be holding valve plate off seat. Also, make sure valve plate or seat is not bent or scored.
3. If leakage occurs between plunger rod and 21, tighten nut just enough to stop leakage. Do not over tighten - will cause excessive packing wear.

ASSEMBLY

Install handle. The linkage hook-up shown in figure 1 illustrates the 7:1 ratio and this pump will generally work best at this setting. The paragraph on ratio adjustment will aid you in deciding which ratio you should use and the numbers stamped on the handle and the pump will guide you in making the setting. Example: Should you desire a 4:1 ratio, simply connect 13. Link to pump at position marked "4" and to handle, also, at position marked "4".

CAUTION: Always install 13 link so cross pin is closer to handle than to pump (see figure 4).



MAJOR COMPONENTS LOCATION

DARKENED AREAS INDICATE WHERE PARTS OR ASSEMBLIES ARE USED.

*SEE OPERATORS MANUAL

REF.	DESCRIPTION	PART NO.	MODEL	
			611305-C	611306-C
A	*METER — GEAR	635142-B		
	*METER — A.T.F.	635151		
B	HOSE & NOZZLE ASS'Y — GEAR	621502-5		
B1	A.T.F. HOSE ASS'Y	621501-05		
B2	BALL	Y16-14		
B3	SPRING	2384		
B4	NOZZLE	1007		
C	HOSE & NOZZLE ASS'Y — A.T.F.	621593-07		
C1	7' HOSE ASS'Y	621501-07		
C2	FILTER	635101		
C3	NOZZLE	629516		
D	WRAPPER — GEAR	61256		
	WRAPPER — A.T.F.	61257		

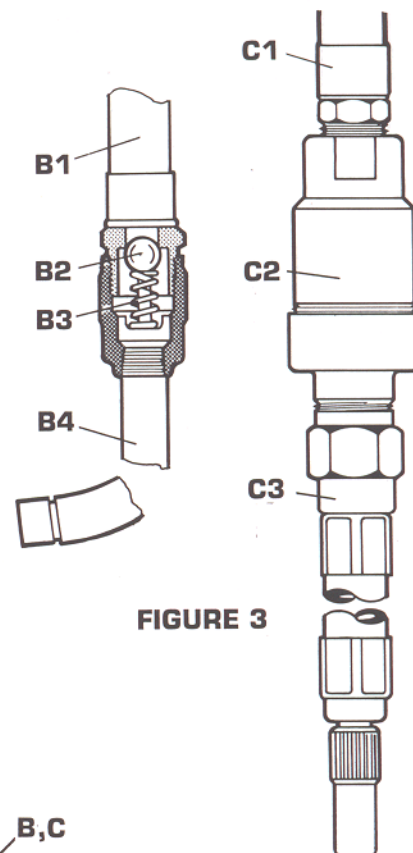
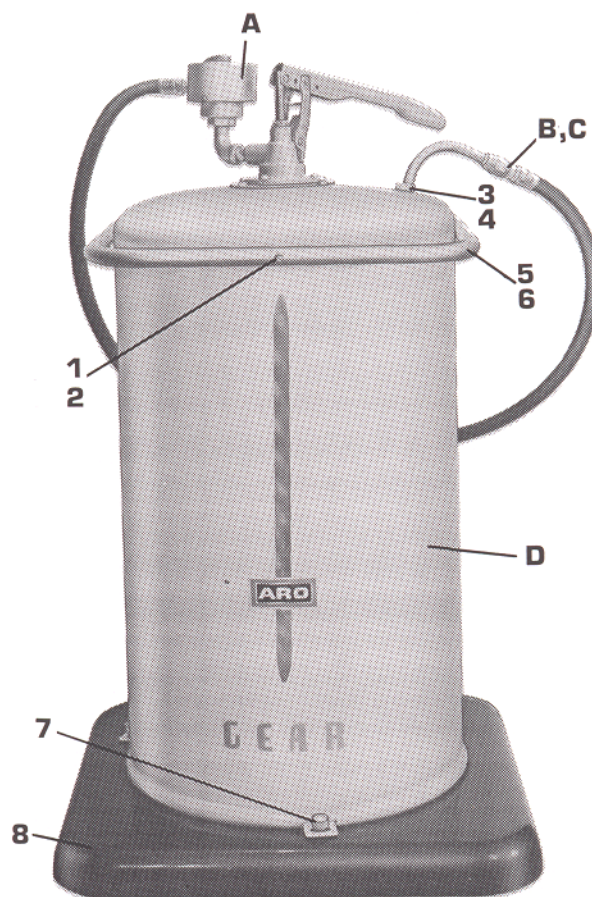

FIGURE 3



MODEL 611305-C SHOWN
FIGURE 2

REF.	DESCRIPTION	QTY.	PART NO.
1	SCREW	4	Y132-113-C
2	STOP NUT	4	Y192-11-C
3	NOZZLE		73934
4	NUT		73935

5	HANDLE		77162
6	PLUG		77163
7	THUMB SCREW	3	3493
8	DOLLY ASM		72497

PARTS LIST

Parts on this page are used on both models
(611305-C, 611306-C)

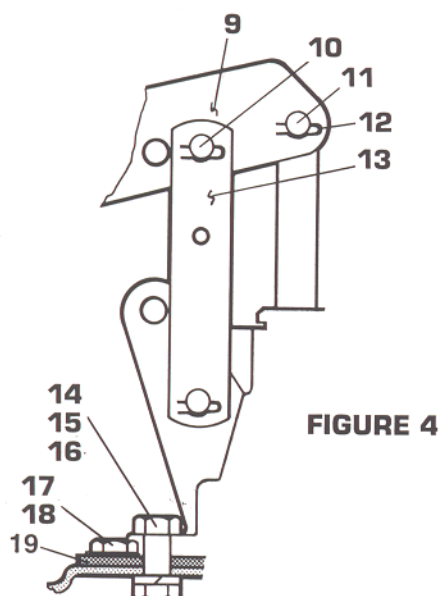

FIGURE 4

REF.	DESCRIPTION	QTY	PART NO.
9	LEVER		72001-1
10	PIN	2	72834
11	PIN		72833
12	RETAINER	3	72835
13	LINK		72027
14	SCREW	3	Y6-53-C
15	NUT	3	Y12-5-C
16	LOCK WASHER	3	Y14-516
17	SCREW	4	Y6-41-C
18	WASHER	4	Y15-45-C
19	MOUNTING PLATE		72507

72529 ASS'Y

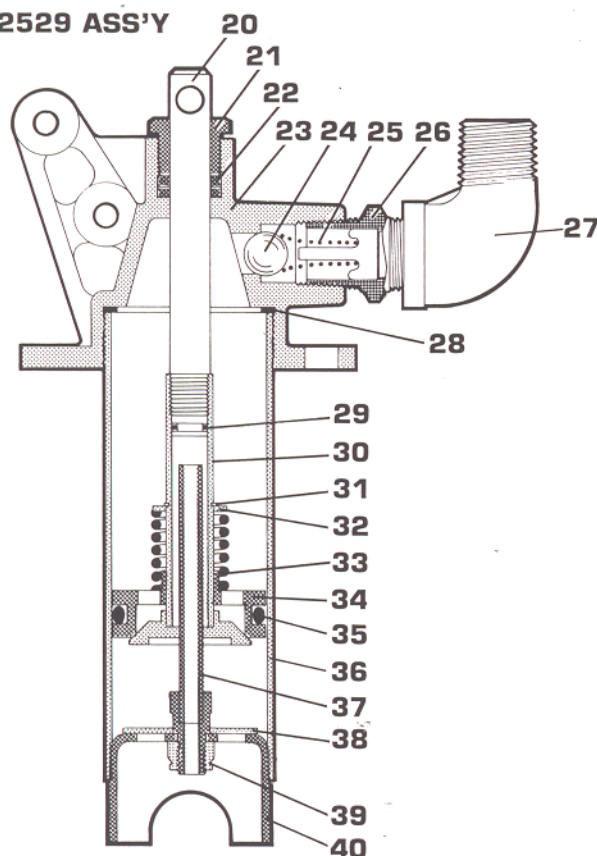

FIGURE 5

	PUMP ASS'Y		72529
20	ROD		72179-5
21	GLAND		72058
22	PACKING	2	72021
23	PUMP BODY		72013-1
24	BALL		Y16-17
25	SPRING		2384
26	RETAINER & ADAPTER		72185
27	90° ST. ELBOW		Y43-4C
28	GASKET		72056
29	"O" RING		Y325-11
30	VALVE & TUBE ASS'Y		72160
31	SNAP RING		Y145-20
32	WASHER		F15-60
33	SPRING		72016
34	PISTON BODY		72161
35	SEAL RING		72061
36	TUBE		72019-5
37	TUBE & SCREW ASS'Y		72181
38	VALVE PLATE		72042
39	NUT		Y171-5
40	VALVE BODY		72064-2

